

CAST IRON GLOBE VALVES-BS 5152

PN 10, PN 16

SPECIFICATIONS

STRAIGHT PATTERN, BOLTED BONNET, O/S & YOKE TYPE, RISING STEM, FLANGED ENDS AS PER BS 4504/DIN 2532 OR 2533-AS APPLICABLE

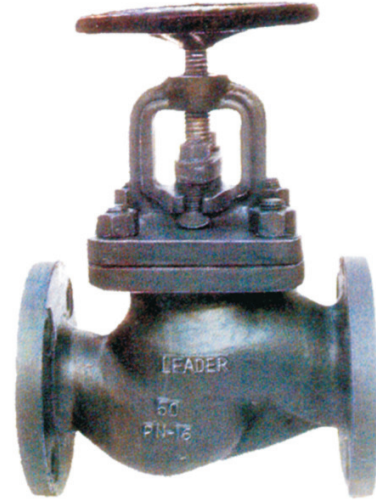
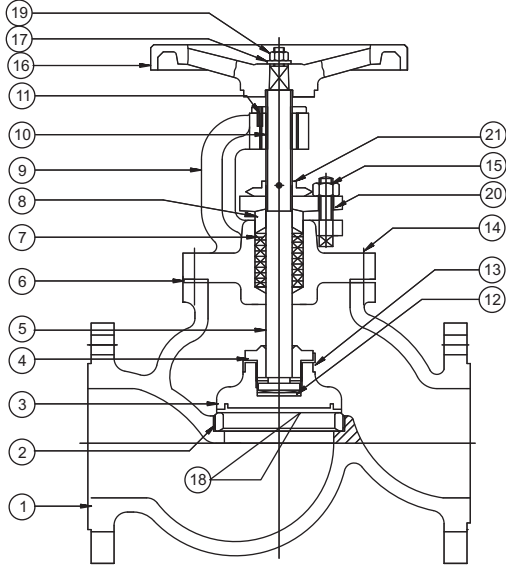

STANDARD MATERIAL COMBINATION

Part No.	QTY.	DESCRIPTION	MATERIALS	
			Cu-ALLOY TRIM	S.S. TRIM
1	1	BODY	C.I. TO EN 1561 Gr. GJL200	C.I. TO EN 1561 Gr. GJL200
2	1	BODY SEAT RING	Cu-ALLOY TO EN 1982 Gr. CC491K	S.S. TO BS 970 Gr. 410 S21/ASTM A182 Gr. F6a/ASTM A276-410 OR THEIR Eq.
3	1	DISC	Cu-ALLOY TO EN 1982 Gr. CC491K	S.S. TO BS 970 Gr. 410 S21/ASTM A182 Gr. F6a/ASTM A276-410 OR THEIR Eq.
4	1	STEM NUT	Cu-ALLOY TO EN 1982 Gr. CC491K	S.S. TO BS 970 Gr. 410 S21/ASTM A182 Gr. F6a/ASTM A276-410 OR THEIR Eq.
5	1	STEM	BRASS TO BS 2874 CZ114 OR EN 12165 CW721R	S.S. TO BS 970 Gr. 410 S21/ASTM A182 Gr. F6a/ASTM A276-410 OR THEIR Eq.
6	1	GASKET	C.A.F. TO BS 1832	C.A.F. TO BS 1832
7	-	GLAND PACKING	TO SUIT SERVICE CONDITIONS	TO SUIT SERVICE CONDITIONS
8	1	GLAND FOLLOWER	Cu-Alloy to EN 1982 Gr. CC491K	S.S. TO BS 970 Gr. 410 S21/ASTM A182 Gr. F6a/ASTM A276-410 AISI 410
9	1	BONNET	C.I. TO EN1561 Gr. GJL 200	C.I. TO EN1561 Gr. GJL 200
10	1	YOKE BUSH	AL. BRONZE TO EN 1982 Gr. CC333G	AL. BRONZE TO EN 1982 Gr. CC333G
11	2	LOCKING SCREW	CARBON STEEL	CARBON STEEL
12	1	THRUST PLATE	HARDENED STEEL	HARDENED STEEL
13	1	LOCKING WASHER	BRASS	STAINLESS STEEL TO AISI304
14	TO SUITE	STUDS & NUTS	CARBON STEEL TO BS916	CARBON STEEL TO BS916
15	2 EACH	T-HEAD BOLTS & NUTS	CARBON STEEL (MIN. UTS 392 N/mm ²)	S.S. TO BS 970 Gr. 410 S21/ASTM A182 Gr. F6a/ASTM A276-410 OR THEIR Eq.
16	1	HAND WHEEL	C.I. TO EN1561 Gr. GJL 200	C.I. TO EN1561 Gr. GJL 200
17	1	WASHER	CARBON STEEL	CARBON STEEL
18	1	DISC RING	CAST IRON TO EN 1561 Gr. GTL 200 Cu-ALLOY TO EN 1982 Gr. CC491K	CAST IRON TO BS 1452 Gr.220 S.S. TO ASTM A 182 Gr. F6a OR THEIR Eq.
19	1	NUT FOR HAND WHEEL	CARBON STEEL	CARBON STEEL
20	1	GLAND FLANGE	C.I. TO EN 1561 Gr. GJL 200	C.I. TO EN 1561 Gr. GJL 200
21	1	INDICATOR	GM	BS EN1982 : 99 Gr. CC419K

NOTE: The above data is subject to change without notice.

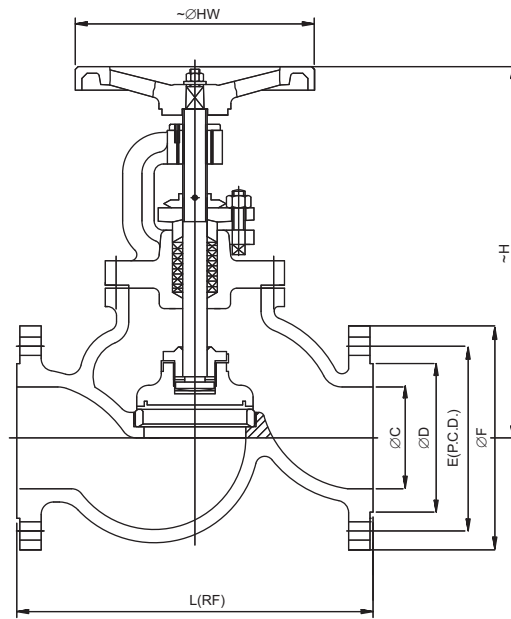

FIG. NO. CI014/CI015

CATALOGUE FIG. NOS.

ITEM	FIG. NO.	END DETAILS
CAST IRON GLOBE VALVE PN 16 (S.S. TRIM)	CI 014 RF	FLANGED ENDS TO DIN 2533 PN-16 RF
CAST IRON GLOBE VALVE PN 10 (S.S. TRIM)	CI 015 RF	FLANGED ENDS TO DIN 2532 PN-10 RF

PRESSURE / TEMPERATURE RATINGS TO BS 5152

NOMINAL PRESSURE	MAX. PERMISSIBLE GAUGE WORKING PRESSURE °C				
	-10 TO 120°C	150°C	180°C	200 °C	220 °C
PN 10	10 bar	9.2 bar	8.5 bar	8.0 bar	8.0 bar
PN 16	16 bar	14.8 bar	13.9 bar	13.0 bar	13.0 bar

DIMENSIONAL DATA

DN NPS	15 1/2	20 3/4	25 1	32 1 1/4	40 1 1/2	50 2	65 2 1/2	80 3	100 4	125 5	150 6	200 8	250 10	300 12	
L (RF)	130	150	160	180	200	230	290	310	350	400	480	600	730	850	
H	165	165	170	200	230	255	305	320	350	405	460	585	640	710	
~ØHW	120	120	120	120	140	140	180	180	235	260	320	400	400	400	
ØC	15	20	25	32	40	50	65	80	100	125	150	200	250	300	
ØD	45	58	68	78	88	102	122	138	158	188	212	268	320	370	
E(PC.D.)	65	75	85	100	110	125	145	160	180	210	240	295	350	400	
ØF	95	105	115	140	150	165	185	200	220	250	285	340	395	445	
ITEM CODE NOS.	Aprox. Wt. ^	4.375	5.875	6.075	11.52	14.92	20.15	32.60	42.50	59.60	84.10	120.2	195.85	370.5	527.7
	PN 10 (S.S. TRIM)	CI 015 D	CI 015 F	CI 015 G	CI 015 H	CI 015 I	CI 015 J	CI 015 K	CI 015 L	CI 015 N	CI 015 O	CI 015 P	CI 015 R	CI 015 S	CI 015 T
	Aprox. Wt. ^	4.375	5.875	6.075	11.52	14.92	20.15	32.60	42.50	59.60	84.10	120.2	195.85	370.5	527.7
	PN 16 (S.S. TRIM)	CI 014 D	CI 014 F	CI 014 G	CI 014 H	CI 014 I	CI 014 J	CI 014 K	CI 014 L	CI 014 N	CI 014 O	CI 014 P	--	--	--

TEST PRESSURES

NOMINAL PRESSURE RATING	SHELL TEST (HYDROSTATIC)	SEAT & BACK SEAT TEST (HYDROSTATIC)	STANDARD NO.
PN 10	15 bar	10 bar	BS5152
PN 16	24 bar	16 bar	

NOTE: The above data is subject to change without notice.

(^WEIGHT GIVEN IN KGS)