

BUTT WELDED ENDS (BWE)

<b>TRIM MATERIAL COMMINATION (ON REQUEST)</b>			
Trim NO.	Seat ring face Part No.2	Disc Ring Face Part No.3	HINGE PIN Part No.5
1	F6a/13%Cr.	F6a/13%Cr.	A276 410
2	F304	F304	A276 304
5	STELLITE	STELLITE	A276 410
8	STELLITE	F6a/13%Cr	A276 410
9	MONEL	MONEL	MONEL
10	F316	F316	F316
13	ALLOY 20	ALLOY 20	A276 410

<b>STANDARD MATERIAL COMBINATION</b>												
S. NO.	PART NAME	Carbon steel to ASTM		Alloy steel to ASTM					Stainless steel to ASTM			
		Type WCB	Type LCB	Type WC1	Type WC6	TypeWC9	Type C5	Type C12	Type CF8	Type CF8M	Type CF3	Type CF3M
1	BODY	A216 WCB	A352 LCB	A217 WC1	A217 WC6	A217 WC9	A217 C5	A217 C12	A351 CF8	A351 CF8M	A351 CF3	A351 CF3M
4	HINGE	A216 WCB	A352 LCB	A217 WC1	A217 WC6	A217 WC9	A217 C5	A217 C12	A351 CF8	A351 CF8M	A351 CF3	A351 CF3M
6	GASKET	Stainless steel + Graphoil										
7	COVER	A216 WCB	A352 LCB	A217 WC1	A217 WC6	A217 WC9	A217 C5	A217 C12	A351 CF8	A351 CF8M	A351 CF3	A351 CF3M
8	BONNET STUDS & NUTS	A193 B7 A194 2H	A320 L7 A194 4	A193 B7 A194 2H	A193 B16 A194 4	A193 B16 A194 4	A193 B16 A194 4	A193 B6 A194 4	A193 B8 A194 8	A193 B8 A194 8	A193 B8 A194 8	A193 B8 A194 8
9	PIN	STEEL										
10	DISC NUT	A276 410	A276 304	A276 410	A276 410	A276 410	A276 410	A276 410	304	316	304L	316L
11	WASHER	A276 410	A276 304	A276 410	A276 410	A276 410	A276 410	A276 410	304	316	304L	316L
12	PLUG	A276 410	A276 304	A276 410	A276 410	A276 410	A276 410	A276 410	304	316	304L	316L
13	PLUG GASKET	C.A.F.										

<b>TEST PRESSURES</b>					
CLASS	SHELL TEST (HYDROSTATIC)		SEAT TEST		
			HYDROSTATIC		PNEUMATIC
150	30 Bar g	435 Psi g	22 Bar g	319 Psi g	6.9 bar 100 Psi g
300	76 Bar g	1102 Psi g	55 Bar g	780 Psi g	6.9 bar 100 Psi g

NOTE: The above data is subject to change without notice.

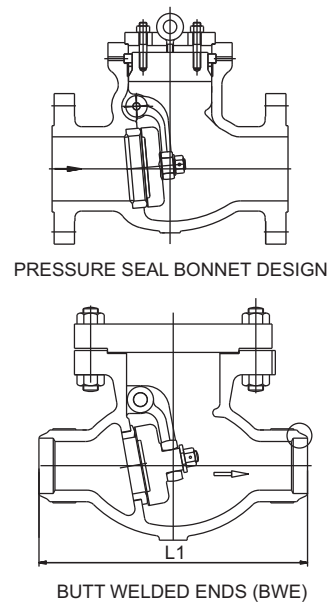
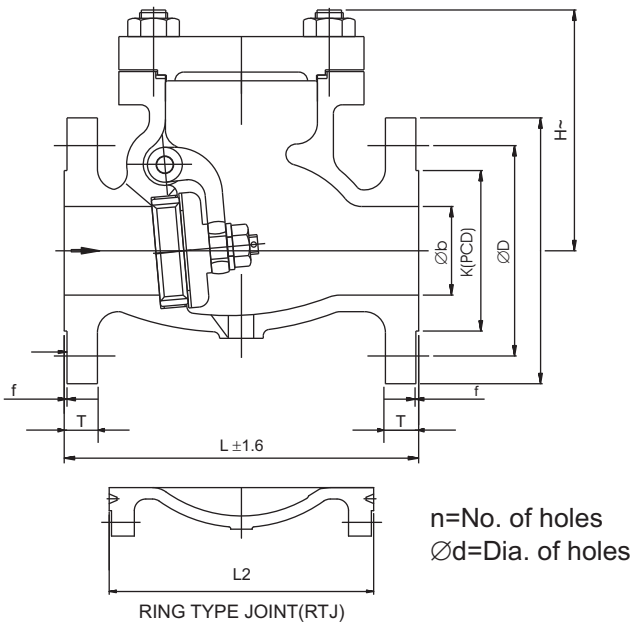

**DIMENSIONAL DATA CLASS - 150**

DN	40	50	65	80	100	125	150	200	250	300	350	400	450	500	600
NPS	1 ½	2	2 ½	3	4	5	6	8	10	12	14	16	18	20	24
L	165	203	216	241	292	330	356	495	622	698	787	864	978	978	1295
L1	165	203	216	241	292	330	356	495	622	698	787	864	978	978	1295
D	127	152	178	190	229	254	279	343	406	483	533	591	635	698	813
T	14.3	15.9	17.5	19.1	23.8	23.8	25.4	28.6	30.2	31.8	35	36.5	39.7	42.9	47.6
K(PCD)	98.5	120.6	139.7	152.4	190.5	215.9	241.3	298.4	362	431.8	476.2	539.8	577.8	635	749.3
n	04	04	04	04	08	08	08	08	12	12	12	16	16	20	20
d	15.9	19	19	19	19	22.2	22.2	22.2	25.4	25.4	28.6	28.6	31.8	31.8	34.9
H	130	140	165	168	190	228	230	261	345	356	425	468	540	600	680
Øb	38	51	64	76	102	127	152	203	254	300	337	387	438	489	591
Aprox.Wt. ^	12	17	27.1	34.5	56	76	93	159	277	580	487	715	905	986	1400

**DIMENSIONAL DATA CLASS - 300**

DN	40	50	65	80	100	125	150	200	250	300	350	400	450	500	600
NPS	1 ½	2	2 ½	3	4	5	6	8	10	12	14	16	18	20	24
L	241	267	292	318	356	400	444	533	622	711	838	864	978	1016	1346
L1	241	267	292	318	356	400	444	533	622	711	838	864	978	1016	1346
D	156	165	190	210	254	279	318	381	444	521	584	648	711	775	914.5
T	20.6	22.2	25.4	28.6	31.8	34.9	36.5	41.3	47.6	50.8	54	57.2	60.4	63.5	70
K (PCD)	114.3	127	149.2	168.3	200	235	269.9	330.2	387.3	450.8	514.4	571.5	628.6	685.3	813
n	04	08	08	08	08	08	12	12	16	16	20	20	24	24	24
d	22.2	19	22.2	22.2	22.2	22.2	22.2	25.4	28.6	31.8	31.8	35	35	35	41
H	145	170	182	200	216	320	275	332	385	455	520	785	785	867	1026
Øb	38	51	64	76	102	127	152	203	254	305	337	387	432	483	584
Aprox.Wt. ^	22.3	29	51.1	54.5	75	161.5	161.5	240	380	584	729	865	---	---	---

Note : Add 3mm in face to face for RTJ flanges ends.

The above data is subject to change without notice

(^WEIGHT GIVEN IN KGS)